

**Maximum Lot Coverage in Residential Zones**  
**Eugene Code Table 9.2751 Special Development Standards**

Zoning	R-1	R-1.5	R-2	R-3	R-4
All lots, Excluding Rowhouse Lots	50% of Lot		50% of Lot		
Rowhouse Lots	75% of Lot	75% of Lot	75% of Lot	75% of Lot	75% of Lot

*Note: Hatched area is the computed lot coverage area.*

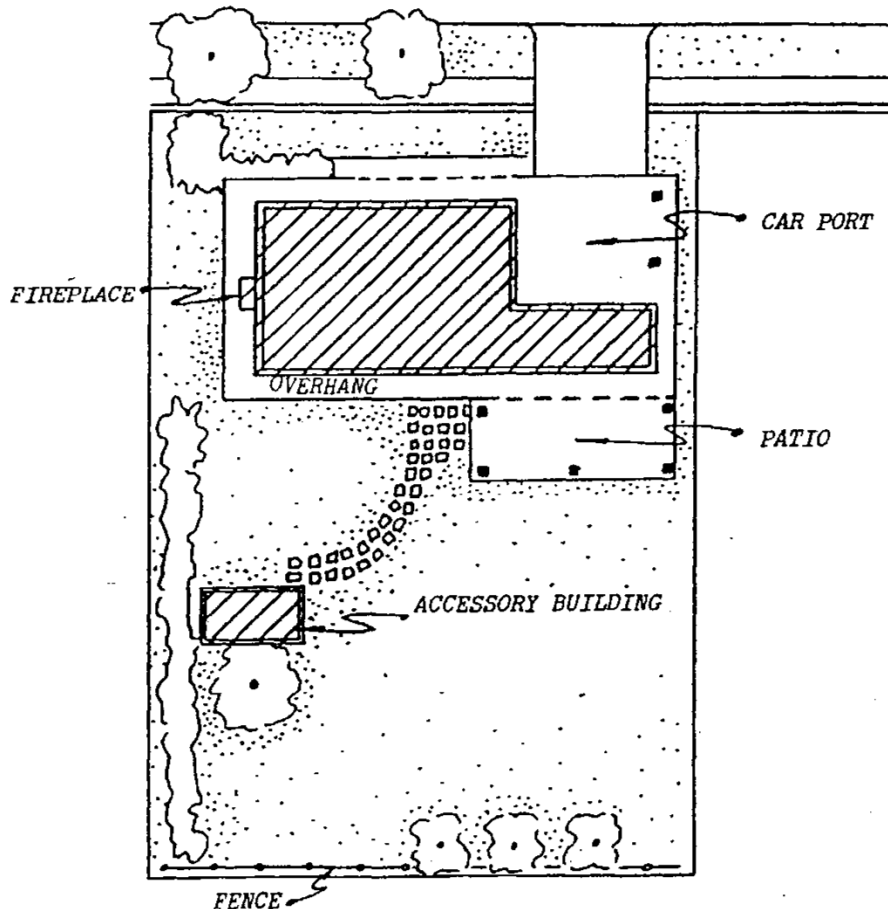

Lot Coverage is that portion of a lot which, when viewed directly from above, would be covered by a building or structure, or any part thereof, except that the following structures or parts of structures shall themselves not be included in calculating lot coverage:

- (A) Any part of a structure without a roof.
- (B) Roof eaves.
- (C) Carports, porches, and balconies that are open at least 50 percent of their respective perimeter. The percentage calculation for adjacent carports, porches and balconies that are separated by a common wall shall be determined individually for each carport, porch, or balcony.

(EC 9.2751 and EC 9.0500 definitions for "Lot Coverage")

Please contact Land Use staff at 541-682-8336 or [landuseinfo@ci.eugene.or.us](mailto:landuseinfo@ci.eugene.or.us) for more information.

*Note: This document should not be used as a substitute for codes and regulations. The applicant is responsible for compliance with all code and rule requirements, whether or not described in this document.*

[www.eugene-or.gov/bps](http://www.eugene-or.gov/bps)